

2 0 2 2

FORWARD
BY FAITH

2 0 2 5

CULTIVATE CHURCH NASHVILLE

FUTURE GROWTH INITIATIVE

LETTER
FROM
PASTOR
**DANIEL
MORRIS**

In 2019, the 7 founding members planted the seeds of an unwavering vision. Today, Cultivate Church Nashville continues to witness and nurture the fertile roots of lives saved. We've watched the Lord grow His church in the middle of a global pandemic. Empowered by the Holy Spirit and the truth of God's word, we've grown in faith and number. So let's stay open to how God wants to use us to build His kingdom and move our mission and ministry forward.

Given the times, we must improve our organizational structure to accommodate, sustain, and foster healthy growth. To continue cultivating our mission, we need to build a larger space to spread God's love and transform His power to all people. God's will and grace and our profound faith will be enough- and it always has been!

Therefore, this brochure shares how God might use us to build His kingdom. It details what it will take over the next 3-years. This is an opportunity to continue growing our faith, future, and legacy for generations to come. Compelled by Christ's love, let's embrace the need to build and grow- individually and as a community. It's a "GOD-SIZED" vision beyond what we can imagine. By listening to Him, we'll discover what's required of us. And when He works through us, we'll give Him the glory. Let's not stand still. Let's move Forward By Faith.



WHO WE ARE 4

OUR HISTORY 6

HISTORICAL NUMBERS 9

2022 GOALS 10

FINANCIAL OBJECTIVES 11

A LOOK INTO THE FUTURE 12

OUR JOURNEY 14

ETERNAL IMPACT 15

TABLE OF **CONTENTS**



WHO
WE ARE



IDENTITY

We are a non-denominational group of believers who desire to experience real life-change by the power of the Word of God, through the work of the Holy Spirit

VALUES

Prayer, Spiritual Freedom, A Lifestyle of Worship, Discipleship, Missions, Service, Love, Biblical Community, Authenticity, Transparency, Humility, Identity in Christ

MISSION

To bring the love and transforming power of Christ to all people

VISION

To be a dynamic and growing church committed to seeing people in Middle Tennessee, The United States, and around the world be saved, be set free from the bondage of sin, and be growing every day in their relationship with Jesus Christ





« **AUG 2019**

Began as a small group gathering on Saturday Nights.

2 0 1 9

NOV 3 2019 »

1st Sunday service @ "Whispering Valley Farm" with 75 in attendance (baptized 4).



NOV 20 2019

Launched 1st Prayer Service on Wednesday Nights @ The Morris Home.

JAN 2020 »

Moved to The Jarrell home in Brentwood.



2 0

OUR HISTORY

APR 5 2020 »

Launched ONLINE ministry (due to COVID shut-down).





« MAY 31 2020

Relaunched in-person services - 56 in attendance on the lawn (5 baptized).



« JUNE 28 2020

Whispering Valley Church signed its official church charter with 48 charter member signatures.

JULY 5 2020 »

1st Sunday in the ROOTS BUILDING - 90 in attendance.



AUG 2020 »

Taylor Mann added to staff as Executive Ministry Assistant.



20

AUG 30 2020 »

"Whispering Valley Church" officially became "Cultivate Church Nashville"



OUR HISTORY

OCT 1 2020 »

Mike Taylor became Cultivate Church's 1st Discipleship and Missions Minister



OUR HISTORY

8



« NOV 3 2020

Cultivate Church Nashville
celebrated 1 year as a church

20



« APR 12 2021

Tanner Hostetter became
Cultivate Church's 1st
Student Minister.



« MAY 2 2021

Held 1st Missions Conference
with 104 in attendance.



JUNE 2021 »

CCN sent its first
Mission Team to Kansas City.



« JULY 4 2021

Celebrated 1 year at the
ROOTS Building.



2 1



« **AUG 2021**
CANVAS student
ministry launched.

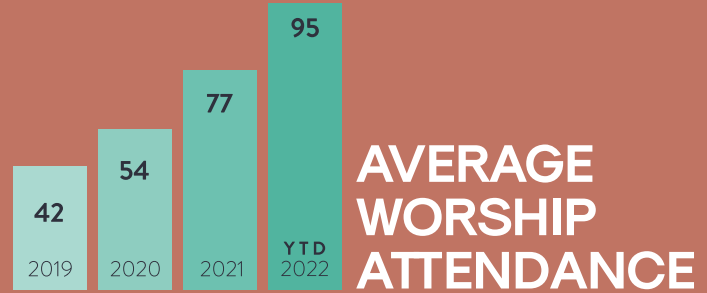

GIVING TRENDS

AVG MONTHLY INCOME	2021	2022	ANNUAL INCOME	2020	2021
	\$22,750.00	\$29,300.00		\$239,276.18	\$387,801.17

NOV 7 2021 »
CCN celebrated 2 years as a church and moved into the MAIN ROOTS BUILDING.



2022 BUDGET **\$375,300.00**



« **NOV 7 2021**
Daniel Dovel became
CCN's 1st Worship Minister.

HISTORICAL NUMBERS



2022 GOALS

ORGANIZATIONAL

LAUNCH

- › Deacon Ministry Team
- › Financial Ministry Team

MISSIONAL

- › Host annual missions conference with representatives from all our Mission Partner Organizations
- › Commission 2 mission teams on the field

WORSHIP

- › Move to 2 services by Summer
- › Move to New LEASED LOCATION
- › Grow to 150 avg in worship

DISCIPLESHIP

- + 5 Adult Bible Study Classes
- + 2 Children's Classes
- + 1 Children's Minister

Bible Study groups to become the Growth agents of CCN by providing:

- › Strong Bible Study
- › Fellowship
- › Outreach Opportunities
- › In-care



RAISE \$2M

OVER THE NEXT 3 YEARS TO:

- Find and Outfit a Leased Building ■
- Supplement Monthly Lease Payments ■
- Preliminary Plan for Purchase of Land ■
and Permanent Campus Buildout

FINANCIAL
OBJECTIVES
2022 - 25

A
LOOK
INTO
THE
FUTURE



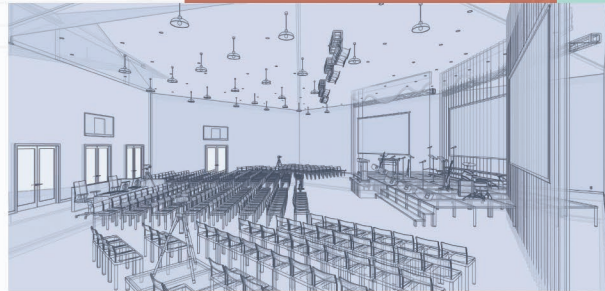
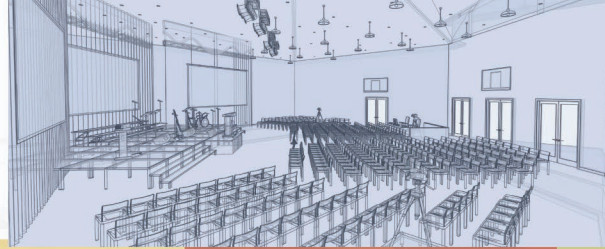

OUR JOURNEY

Ask God what or how
He wants you to give as
an individual or family.

01
PRAY

Remain open to how
He wants you to contribute to
the growth of His kingdom.

02
LISTEN

Take a brave step of faith and
follow through on
His instructions to you.

03
OBEY

Prepare to see how
God works through us
for His will to be done.

04
WATCH

As you view this chart as a snapshot of what's possible, consider this. To move Cultivate Church forward, we must do it together! **It is not about equal giving, but equal sacrifice.** We know many have already given their time, talents, and treasures. Today, we ask everyone to pray boldly for the proper discernment to give generously. Consider contributing above and beyond your current tithes and offerings. According to God's plan and will, let's move forward with stronger faith in Him. Let Him work through you. Your gifts in this 3-year journey will pave the clearest path towards lasting impact—in Nashville and beyond.

MONTHLY	YEARLY	3-YEAR TOTAL
\$25	\$300	\$900
\$50	\$600	\$1,800
\$75	\$900	\$2,700
\$100	\$1,200	\$3,600
\$200	\$2,400	\$7,200
\$500	\$6,000	\$18,000
\$750	\$9,000	\$27,000
\$1,000	\$12,000	\$36,000
\$1,500	\$18,000	\$54,000
\$2,000	\$24,000	\$72,000
\$5,000	\$60,000	\$180,000
\$10,000	\$120,000	\$360,000

ETERNAL
IMPACT
POTENTIAL

cultivatechurchnashville.com 

615.669.2733 

320 Southgate Ct.
Brentwood, TN 37027 

P.O. Box 1083 
Nolensville, TN. 37135

